

KJSC TYPE

CLEAN ROOM · 저소음 · 저분진

Link와 Link를 Band Pin으로 연결하는 구조로 되어있어 기장의 늘임과 줄임이 가능하고 고속주행에도 저소음 저분진을 유지하여 주어 반도체 생산설비, Display 장비 등 Clean Room 환경의 최적의 제품입니다.

CLEAN ROOM

LINKS ARE CONNECTED BY BAND PIN SO THE LENGTH CAN BE LENGTHENED AND SHORTENED WHILE HIGH-SPEED TRAVELING, IT KEEPS LOW NOISE AND LOW DUST, IT IS AN OPTIMUM PRODUCT FOR CLEANROOM ENVIRONMENT SUCH AS SEMICONDUCTOR PRODUCTION FACILITIES, DISPLAY EQUIPMENT.



KJSC 17 TYPE

Cablechain / Chain Pitch(P)=17mm

Order Example [주문예]

KJSC17 - B20 / Type ▶ R/곡률반경(Radius) ▶ L / 길이값(링크가능) ▶ SET/ 세트수

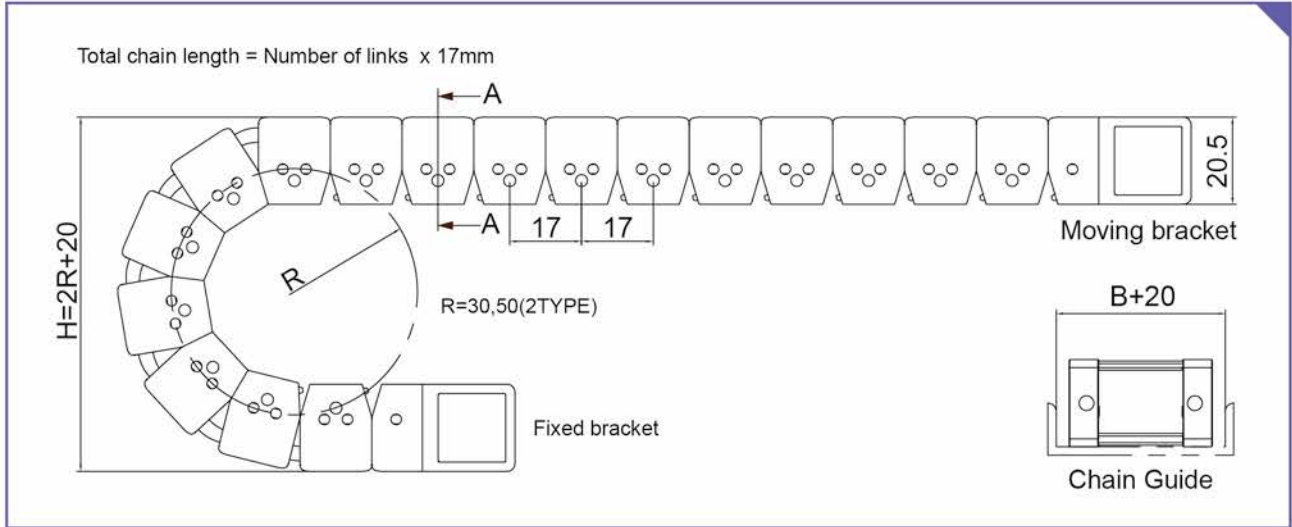

D.Max

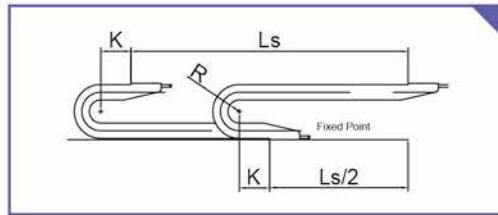
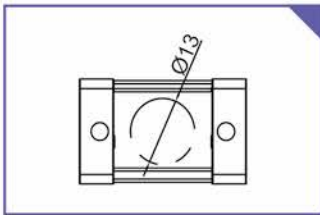

Chain Length $L = Ls/2 + \pi R + 90$

H- 곡률반경에 따른 H값 ±공차가 있음.

R	30	50
H	80	120

Section A-A

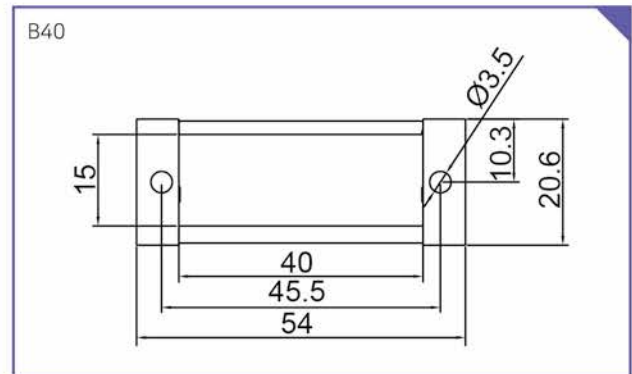
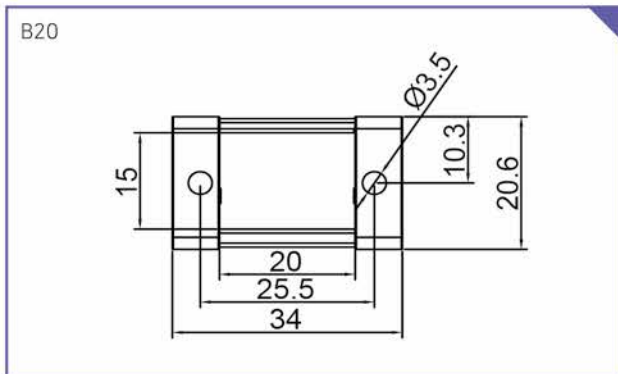

End Bracket

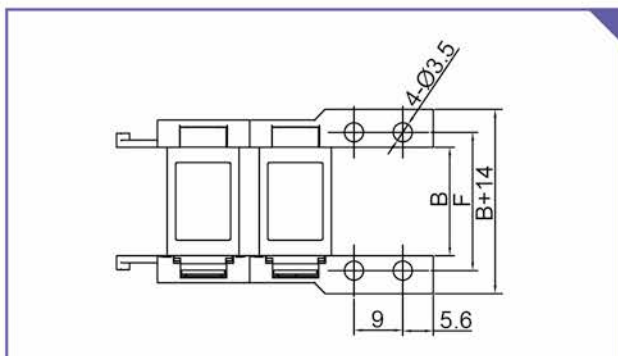

단위 mm

	$F=(B+5.5)$
KJSC17-B20	25.5
KJSC17-B40	45.5

KJSC 24 TYPE

Cablechain / Chain Pitch(P)=24mm

Order Example [주문예]

KJSC24 - B40 / Type ▶ R/곡률반경(Radius) ▶ L / 길이값(링크가능) ▶ SET/ 세트수

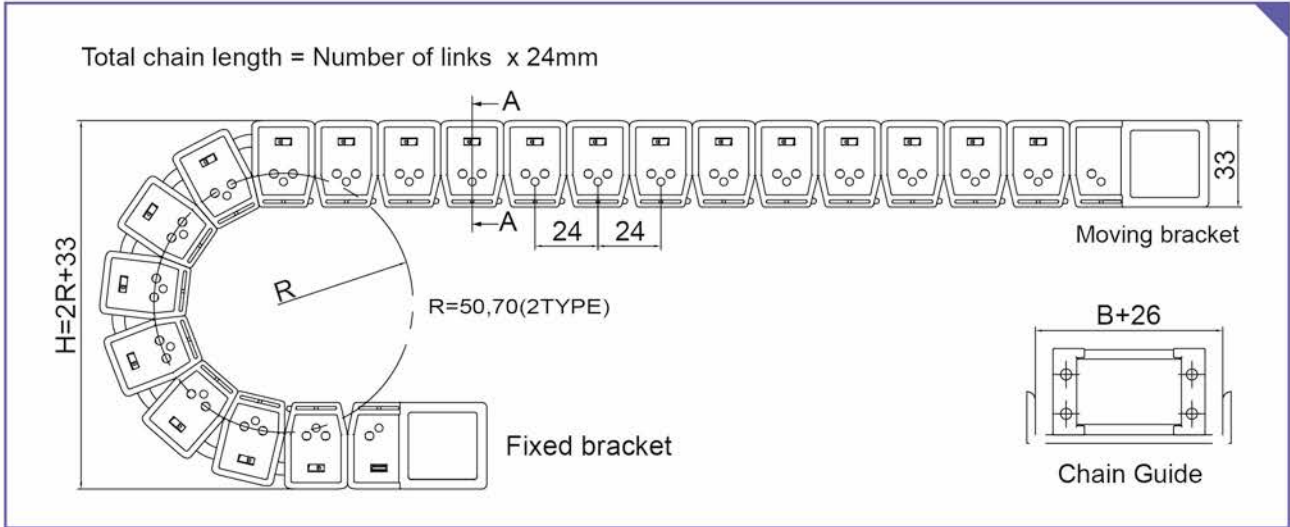

D.Max

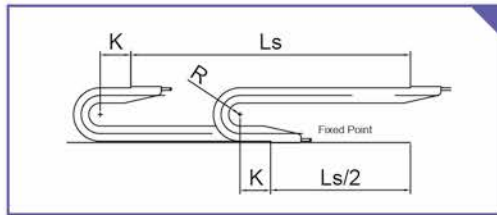
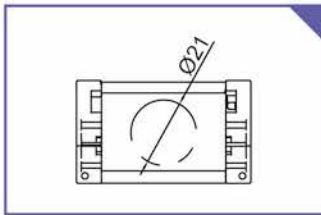

Chain Length $L = Ls/2 + \pi R + 130$
 H- 곡률반경에 따른 H값 ±공차가 있음.

R	50	70
H	133	173

Section A-A

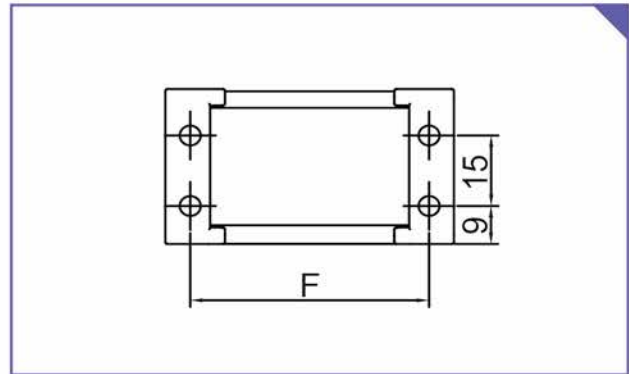
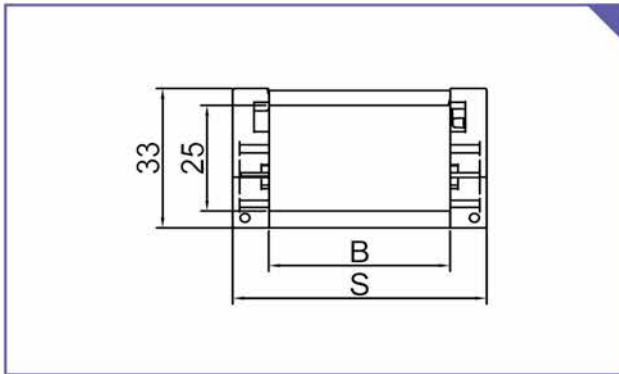

End Bracket

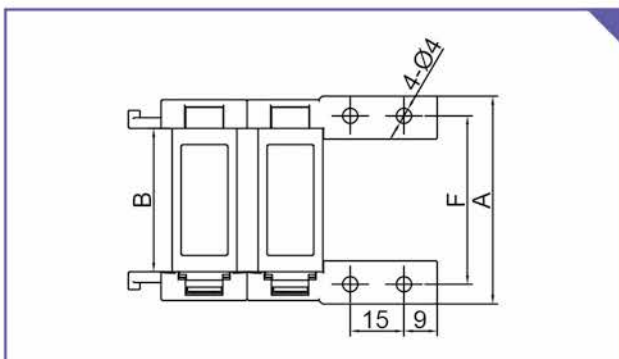

	단위 mm		
	$F=(B+7,5)$	$A=B+18$	$S=B+16$
KJSC24-B40	47.5	58	56
KJSC24-B55	62.5	73	71
KJSC24-B80	87.5	98	96
KJSC24-B110	117.5	128	126

KJSC 32 TYPE

Cablechain / Chain Pitch(P)=32mm

Order Example [주문예]

KJSC32 - B75 / Type ▶ R/곡률반경(Radius) ▶ L/길이값(링크가능) ▶ SET/ 세트수

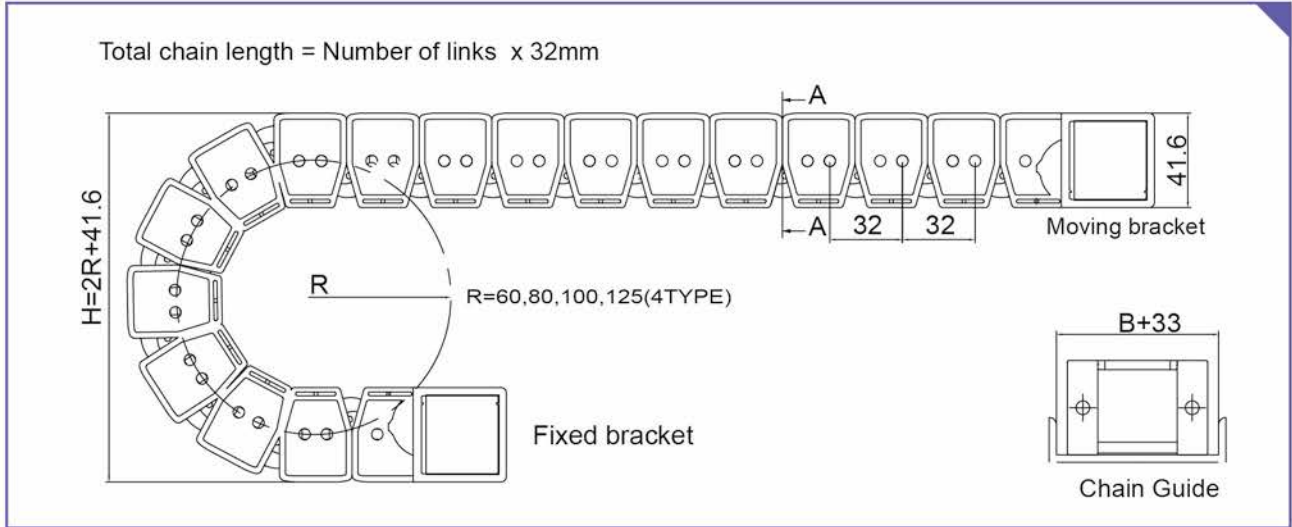

D.Max

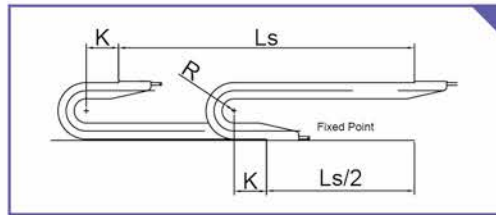
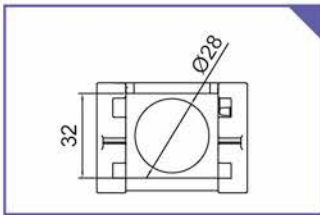

Chain Length $L = Ls/2 + \pi R + 160$

H- 곡률반경에 따른 H값 ±공차가 있음.

R	60	80	100	125
H	161.6	201.6	241.6	291.6

Section A-A

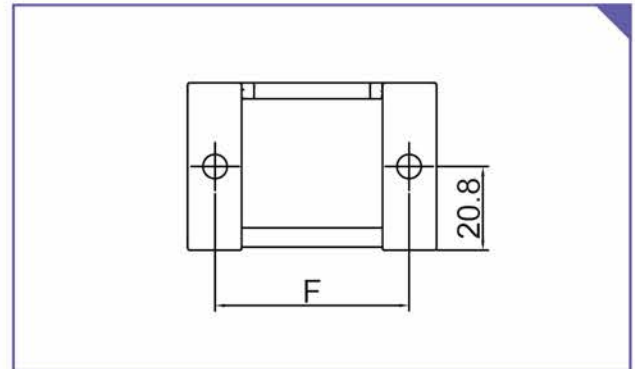
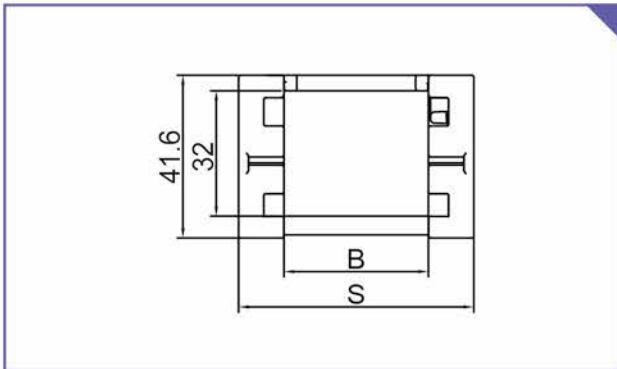

End Bracket

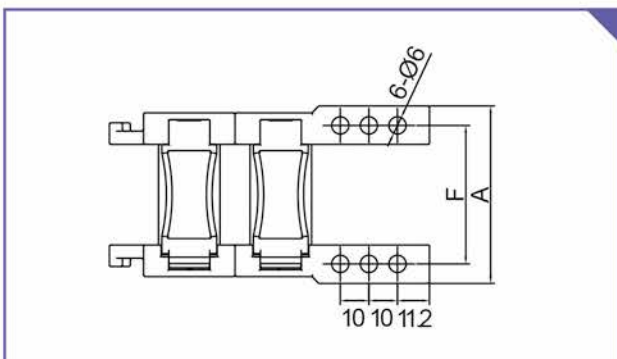

단위 mm

	$F=B+13.2$	$A=B+26.8$	$S=B+22$
KJSC32-B35	48.2	61.8	57
KJSC32-B55	68.2	81.8	77
KJSC32-B75	88.2	101.8	97
KJSC32-B100	113.2	126.8	122

KJSC 40 TYPE

Cablechain / Chain Pitch(P)=40mm

Order Example [주문예]

KJSC40 - B50 / Type ▶ R/곡률반경(Radius) ▶ L / 길이값(링크가능) ▶ SET/ 세트수

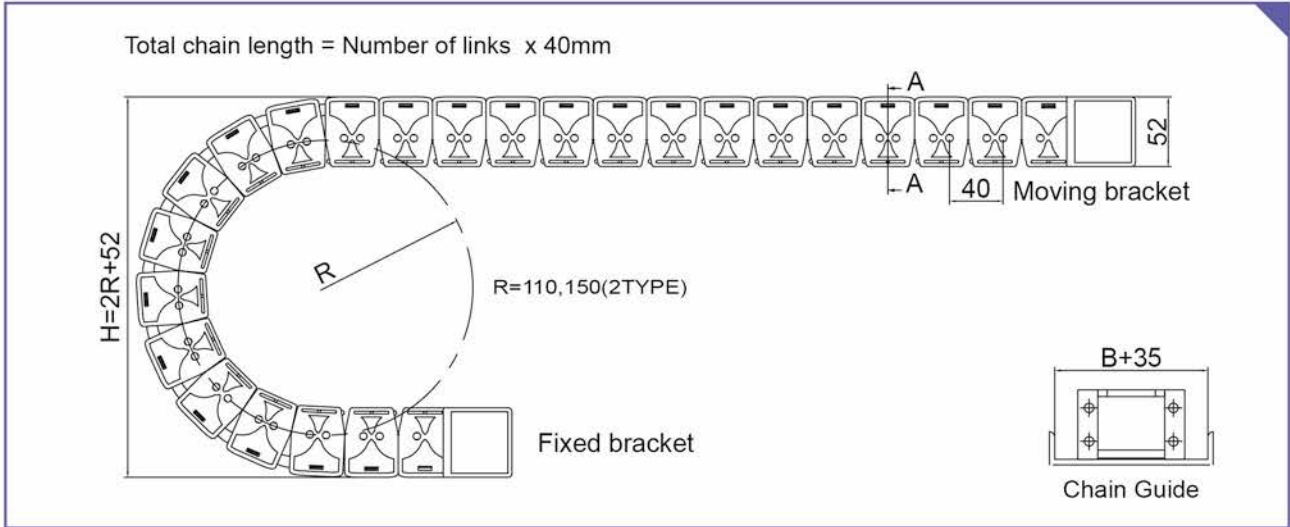

D.Max

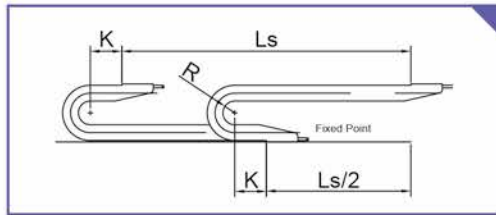
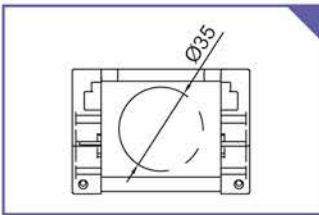

Chain Length $L = Ls/2 + \pi R + 250$

H- 곡률반경에 따른 H값 ±공차가 있음.

R	110	150
H	272	352

Section A-A

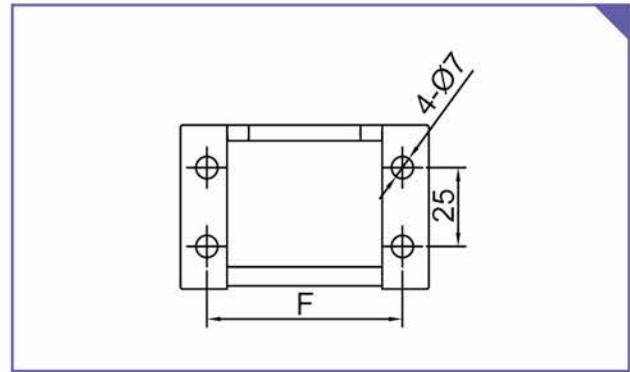
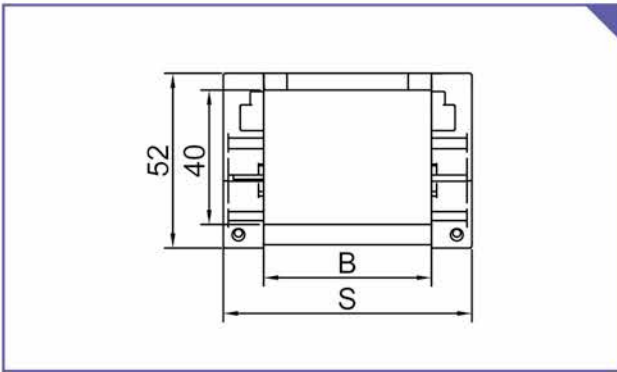

End Bracket

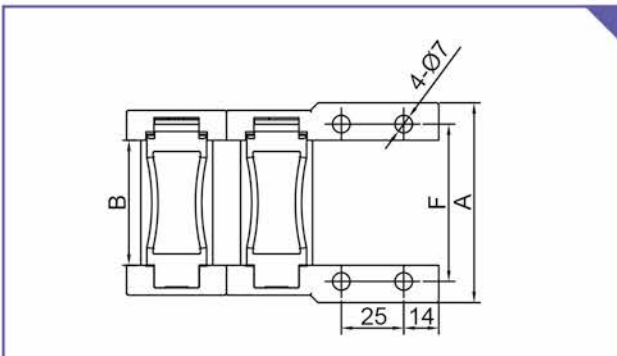

단위 mm

	F=B+13	A=B+30	S=B+24
KJSC40-B50	63	80	74
KJSC40-B70	83	100	94
KJSC40-B100	113	130	124
KJSC40-B150	163	180	174

KJSC 60 TYPE

Cablechain / Chain Pitch(P)=60mm

Order Example [주문예]

KJSC60 - B100 / Type ▶ R/곡률반경(Radius) ▶ L / 길이값(링크가능) ▶ SET/ 세트수

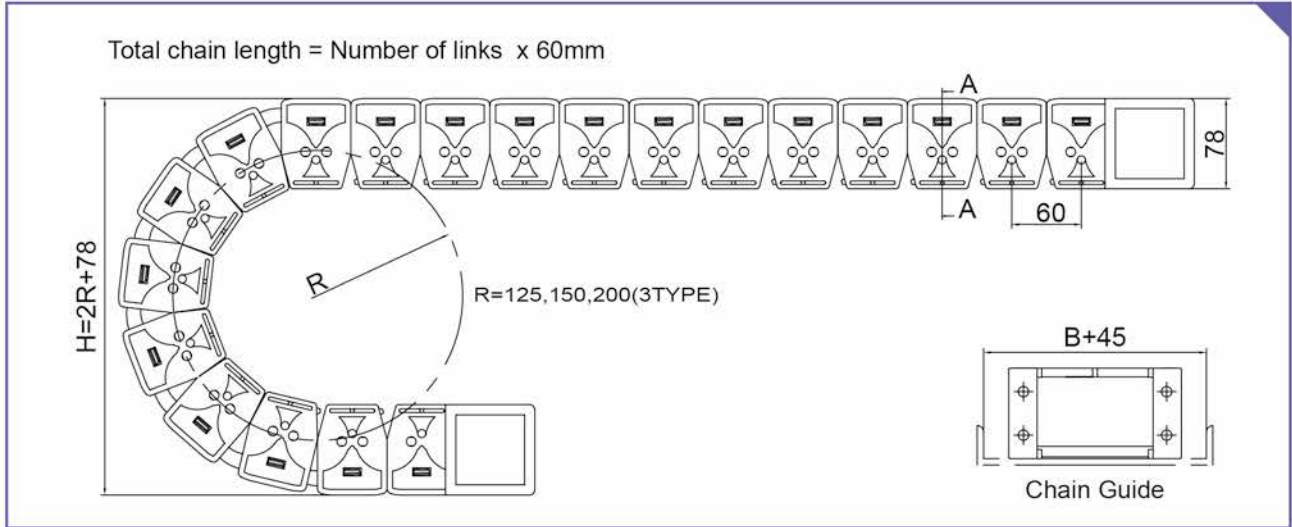

D.Max

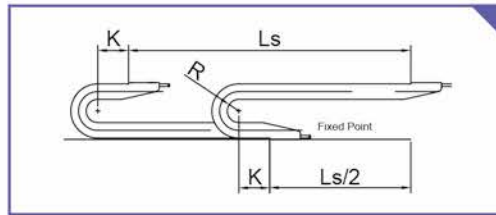
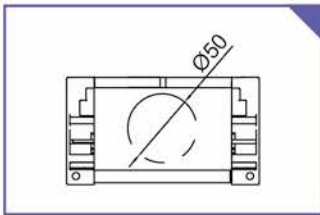

Chain Length $L = Ls/2 + \pi R + 380$

H- 곡률반경에 따른 H값 ±공차가 있음.

R	125	150	200
H	328	378	478

Section A-A

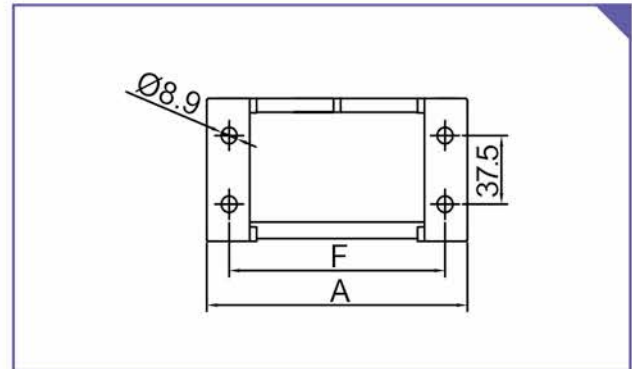
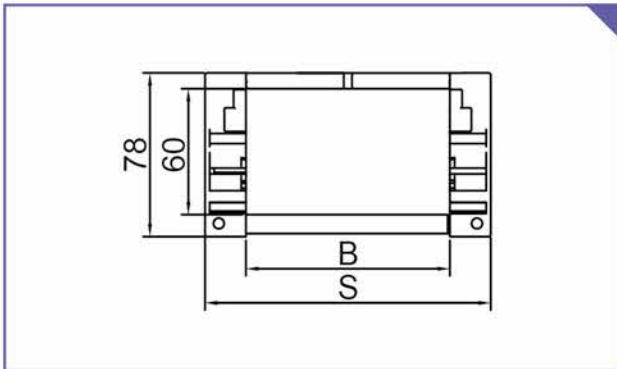

End Bracket

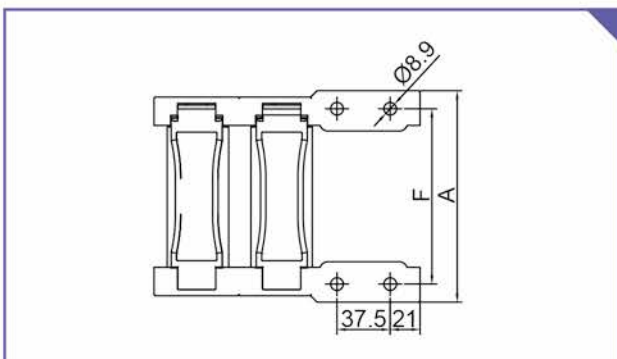

단위 mm

	$F = B + 23.5$	$A = B + 49$	$S = B + 40$
KJSC32-B100	123.5	149	140
KJSC32-B125	148.5	174	165
KJSC32-B150	173.5	199	190
KJSC32-B175	198.5	224	215
KJSC32-B200	223.5	249	240